

A wide-angle photograph of a modern operating room. The room features a central patient table on a mobile cart, surrounded by several large, articulated robotic surgical arms. These arms are equipped with various instruments and cameras. The ceiling is white with recessed lighting, and the walls are a mix of blue and white panels. In the background, there are storage cabinets and a large window. The overall atmosphere is clean, professional, and technologically advanced.

ACIBAD M PROJECT MANAGEMENT

TECHNOLOGICAL
SOLUTIONS

MODULAR SYSTEMS



01 WHAT IS MODULAR SYSTEM

02 MODULAR SYSTEM'S
ADVANTAGES

03 OUR SERVICES

04 PROJECT PROCESSES

05 PRODUCT PORTFOLIO



WHAT IS MODULAR WALL SYSTEM

01



- Modular wall systems are a hygienic and future-ready modern healthcare space construction technology with recyclable and sustainable high quality wall covering systems designed to meet the needs of today's healthcare areas in all aspects.



- Modular systems service, with its unique combination of quality, innovation and aesthetics, is able to meet the new needs of rapidly changing and developing health systems.



ESSENTIALS OF MODULAR SYSTEM

01

- Highly appropriate for sterile areas such as operating rooms, central sterilization and intensive care units.
- Infrastructure, walls, ceilings, floors, doors, medical devices and all other requirements that are completely independent of existing structural walls and supports are locked together to ensure maximum sealing as a single structure.
- All modular spaces can be moved to a new location, recovering 90% of the materials.

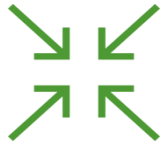



MODULAR SYSTEM'S ADVANTAGES

02



- Durable and long lasting,
- Easily coordinated with other systems compared to projects using traditional construction methods,



- Flexible, easily adapt to new technologies,
- Provides operational efficiency with fast installation and modification,



- Easy and fast cleaning,
- With its simple demountable system, it provides easy access to the infrastructure for repairs or additions.





OUR SERVICES & PROJECT PROCESSES

03

Project Management Process



3D presentation and design



Production of customized products for each project



Ensuring field coordination with all other disciplines and assembly

Medical equipment supply

Turnkey solutions including electrical, mechanical, automation, medical gas and modular systems



PROJECT PROCESSES

04

Pre-Design

The pre-design process is shaped in response to the client's demands and determines the overall framework of the project.

In this process, the material key plan is created, the door types and the type and location of the wall-mounted elements are determined.

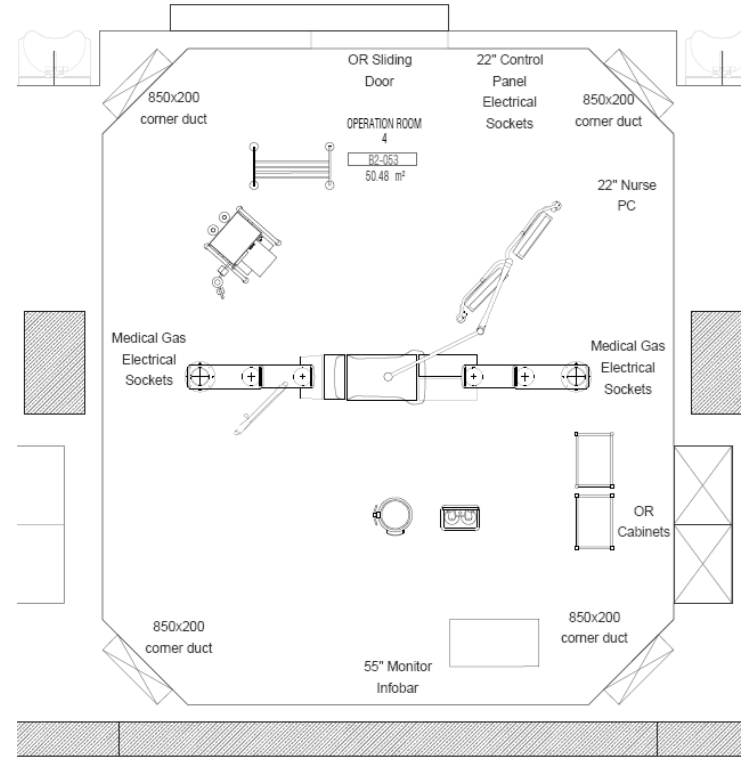
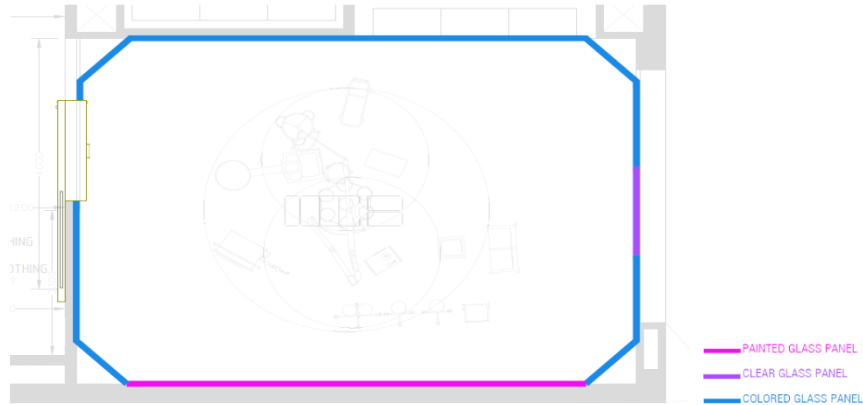



PROJECT PROCESSES

04

On-Site Measurements

On-site measurements are made to observe the existing static structure, mechanical electrical installation and the condition of the field both for existing and new buildings.

The preliminary project is shaped according to the measurement data from the site and sits on a durable basis.

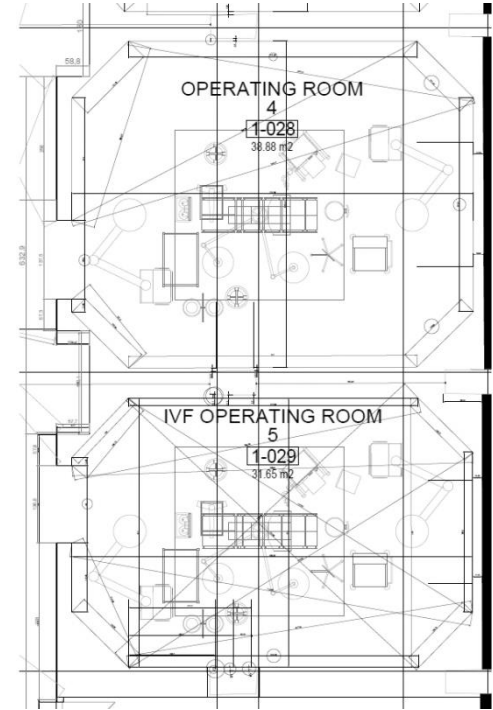
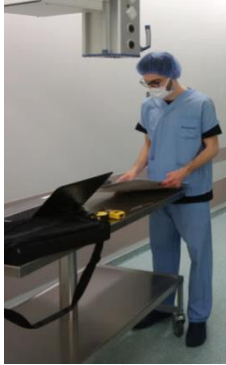



PROJECT PROCESSES

04

Design

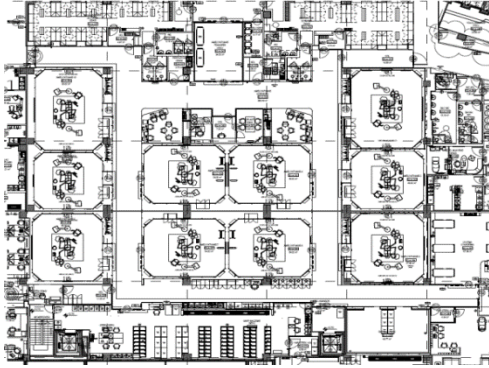

Master Plan



Wall Elevations

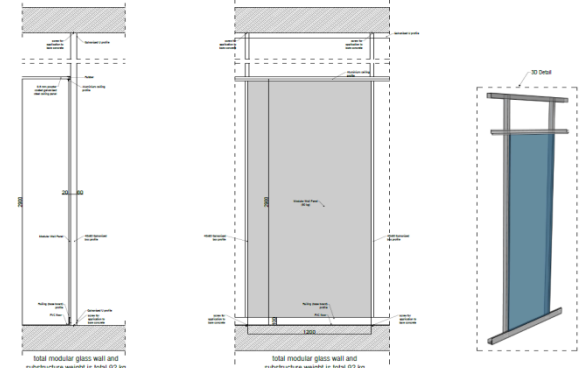

Detail Drawings



It is the process of detailing the data obtained from pre-design and field measurements and turning it into an application project.



Preparation of detailed 2D and 3D BIM projects for production, site installation and coordination



Customized products according to clients demands and Acibadem Project Management's guidance and broad experience.



PROJECT PROCESSES

04

Design

REAL



RENDER

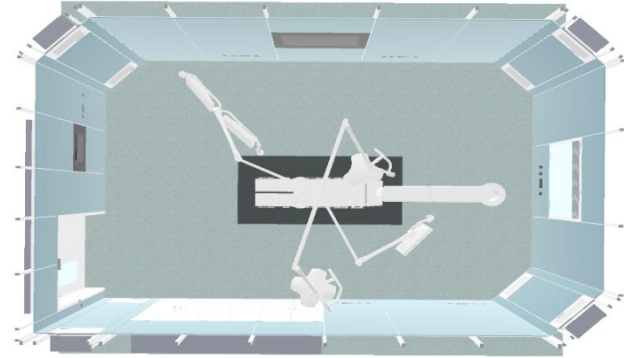

3D models and renderings produced for the customer's review.



PROJECT PROCESSES

04

Installation Order

Application ground
U profile montage

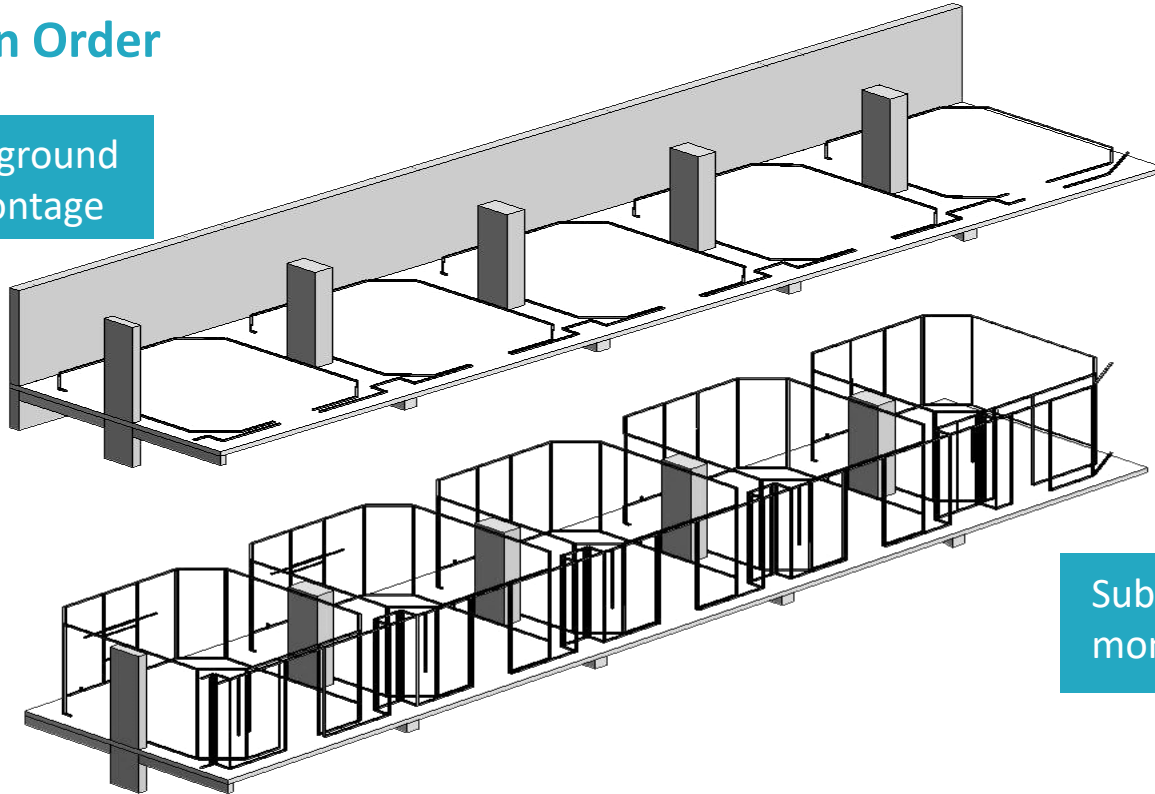

Substructure
montage



PROJECT PROCESSES

04

Installation Order

Wall panel, door and
equipment montage

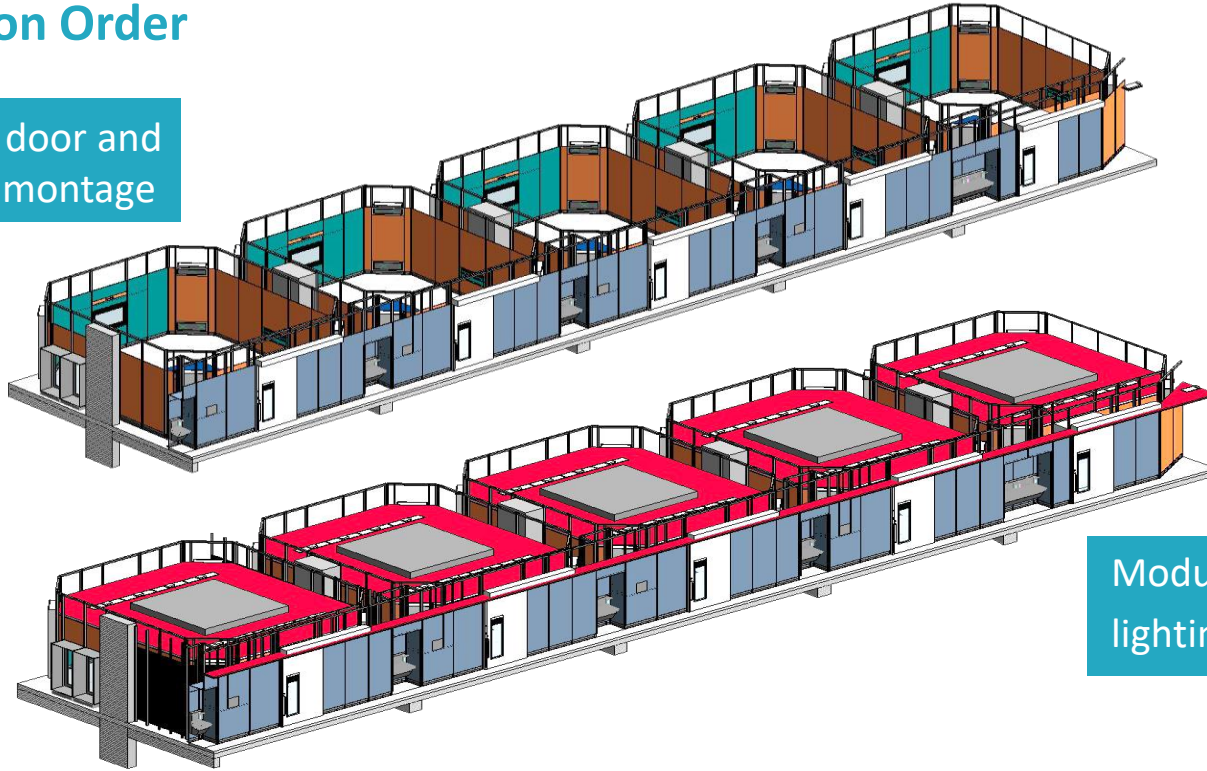

Modular ceiling,
lighting fixture montage



PROJECT PROCESSES

04

Installation

Substructure Montage

Self supporting substructure, which allows a flexible installation of all built in elements to ground and ceiling. Wall panels, doors, wall equipment are fixed to the substructure. Whole system becomes a single unit, maintain the statics between the floor and ceiling.

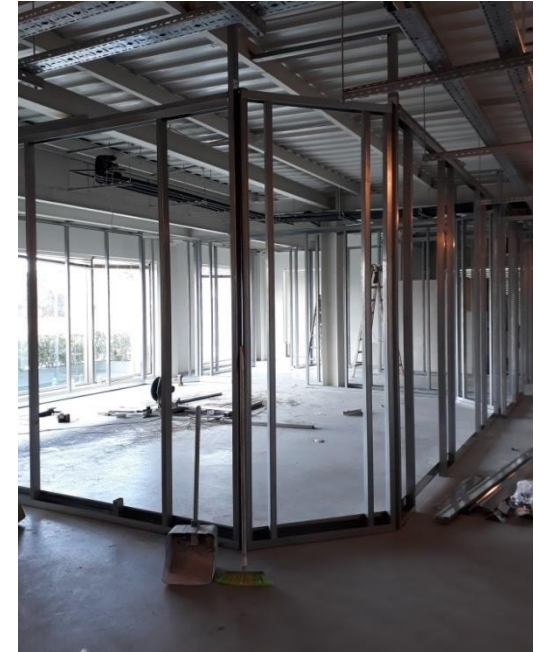



PROJECT PROCESSES

04

Installation

Wall System Montage

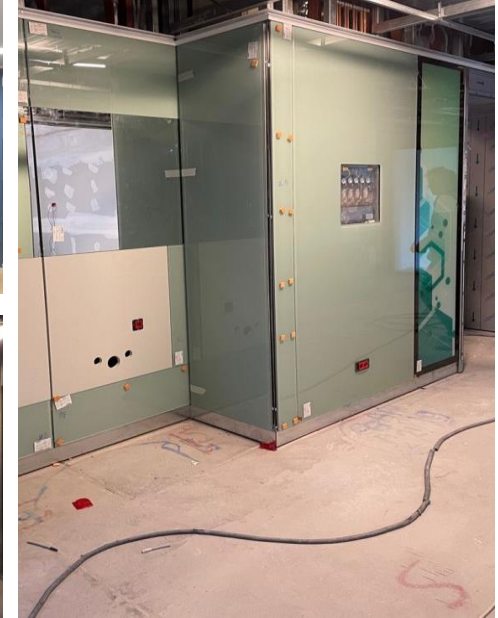





PRODUCT PORTFOLIO

05



- ✓ Wall Systems
- ✓ Door Systems
- ✓ Ceiling Systems
- ✓ Sterile Area Cabinets
- ✓ Sterile Lighting Systems
- ✓ Operating Room Control Panel, Medical Monitor, Nurse PC, X-Ray Viewer, Infobar, Digital Clock
- ✓ Laminar Flow Units, Corner Exhaust Ducts
- ✓ Hand Washing Units
- ✓ Nurse Desks and Benches



PRODUCT PORTFOLIO

05

Wall Systems



Extra-Clear Glass

Glass panel color can be selected from RAL, Pantone or NCS color catalog



Printed Glass

Pattern can be any image in vectoral format



Metal

Panel color can be selected from the RAL K7 color catalogue.



Vision Glass Panel

Double-sided 6 mm clear glass wall panel with automatic blind system





PRODUCT PORTFOLIO

05

Wall Systems

Sliding doors

Stainless steel or glass automatic sliding door leaf and door frame integrated into the modular system, width and height can be defined flexibly according to the project, 3 different door opening modes (full, half, permanent open), door release button activated by knee strike, inspection window with automatic jalousie in various sizes on stainless steel leaves. It can be manufactured with x-ray protection according to requirements.





PRODUCT PORTFOLIO

05

Wall Systems

Hinged Doors

Stainless steel, glass, HPL automatic or manual door leaves and stainless steel door frames integrated into the modular system; width and height can be defined flexibly according to the project, with inspection window if required. It can be manufactured with x-ray protection according to requirements.







PRODUCT PORTFOLIO

05

Ceiling Systems

Ceiling

Clip-in system modular suspended ceiling plates are made of 0.8 mm antibacterial powder coated galvanized steel. Dimensions are 600x600 mm or 600x1200 mm. A special wall-ceiling profile is used for a sterile transition and sealing at the junction points.

Lighting

Lighting elements are designed as dimmable, IP65 class, 6000 lumens, 4000K white light and accessible from under the luminaire for service/repair scenarios. Dimensions are 600x600 mm or 300x1200 mm.

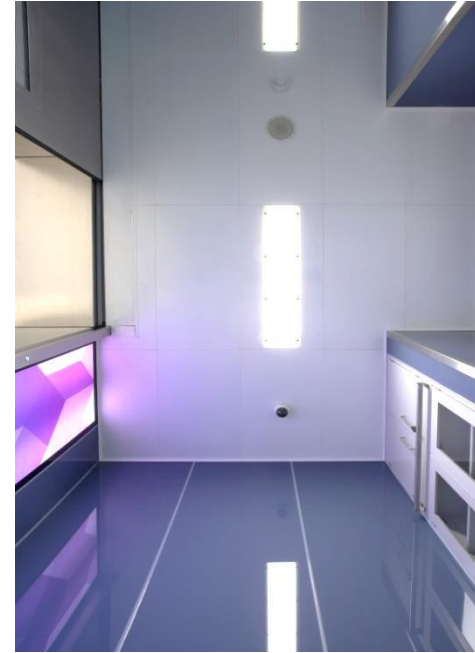
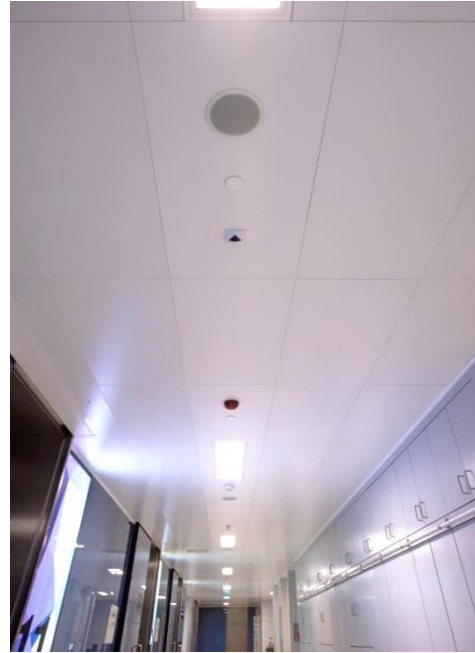



PRODUCT PORTFOLIO

05

Sterile Area Cabinets

Stainless steel cabinets can be produced in any width, height and depth. According to requirements, cabinet doors variations are with/without observation window, or glass-covered. Adjustable shelves, baskets and catheter hangers can be applied.







PRODUCT PORTFOLIO

05

Technological Equipment OR Control Panel

Control panel package; It includes a 21.5" LCD touch monitor with 1920x1080 image quality, a PC, an electrical panel with Java-based software and control elements.

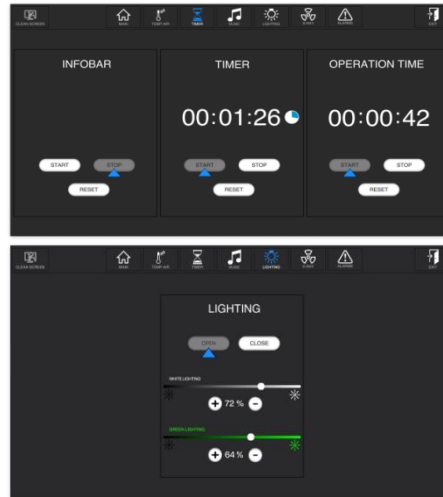
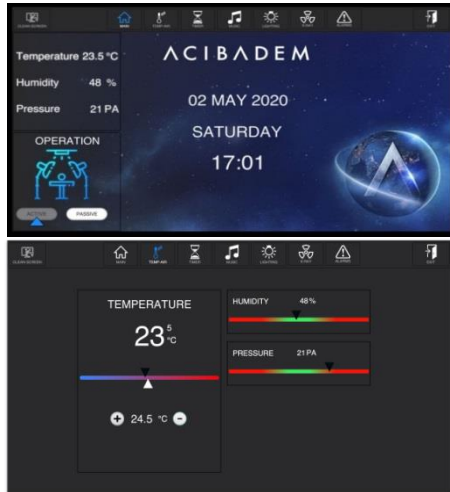



PRODUCT PORTFOLIO

05

Technological Equipment OR Control Panel

The control panel allows to control or monitor the features listed below:

- ✓ Monitoring and controlling the temperature value on the device
- ✓ Monitoring the humidity value
- ✓ Monitoring of room pressure value
- ✓ Lighting ON-OFF, DALI control, dim control of lighting
- ✓ Monitoring of isolated power supply and UPS
- ✓ Monitoring of medical gas alarms
- ✓ Blind control of vision glasses.

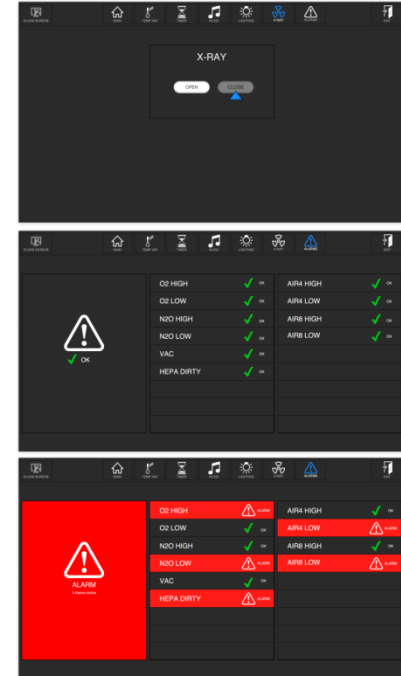



PRODUCT PORTFOLIO

05

Technological Equipment

Medical Monitor, Nurse PC, X-Ray Viewer, Infobar, Digital Clock





PRODUCT PORTFOLIO

05

Mechanical Equipment

Laminar Flow Unit, Corner Exhaust Duct

Laminar Flow Unit

AISI 304 stainless steel or antibacterial coated galvanized steel body with high performance silk fabric laminator and H14 Hepa Filter.

Corner Exhaust Duct

Stainless Steel flush mounted fiber holders and 1.2 mm galvanized steel exhaust air intake ducts with special airtight connection outlets. Exhaust duct is a part of wall substructure and ready to connecting with main ventilation system.

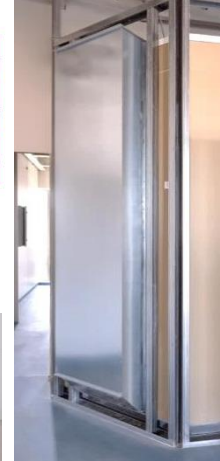
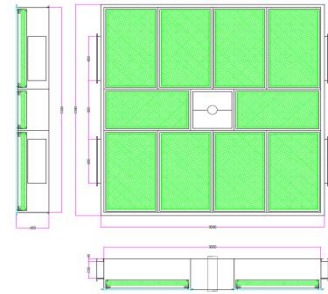



PRODUCT PORTFOLIO

05

Hand Washing Unit

The scrub hand washing unit, which is made of Corian or stainless steel, has a special sink design that prevents water from splashing. The unit comes ready for installation: Clean and waste water connection pipes are sent to the field mounted on the scrub unit for easy connection to the main line.

Scrub unit package also includes a basin mixer with hot and cold water regulation, soap dispenser, hand cleaner dispenser, brush holder and z-fold towel holder.





ACIBADEM PROJECT
MANAGEMENT OFFICE
MOCK-UP O.R. SHOWROOM



PRODUCT PORTFOLIO

05

Nurse Desk and Benches

Specially designed and produced from corian and laminate materials for the sterile areas in different shapes and sizes suitable for the number of nurses and the architectural layout. Design approach improves nurses' ability to focus and collaborate with teammates.

Seamless wire routing and under-surface cable management keep workspaces free of clutter.









OPERATING ROOM



OPERATING ROOM



OPERATING ROOM



ACIBADEM AMSTERDAM HOSPITAL
NETHERLANDS

OPERATING ROOM

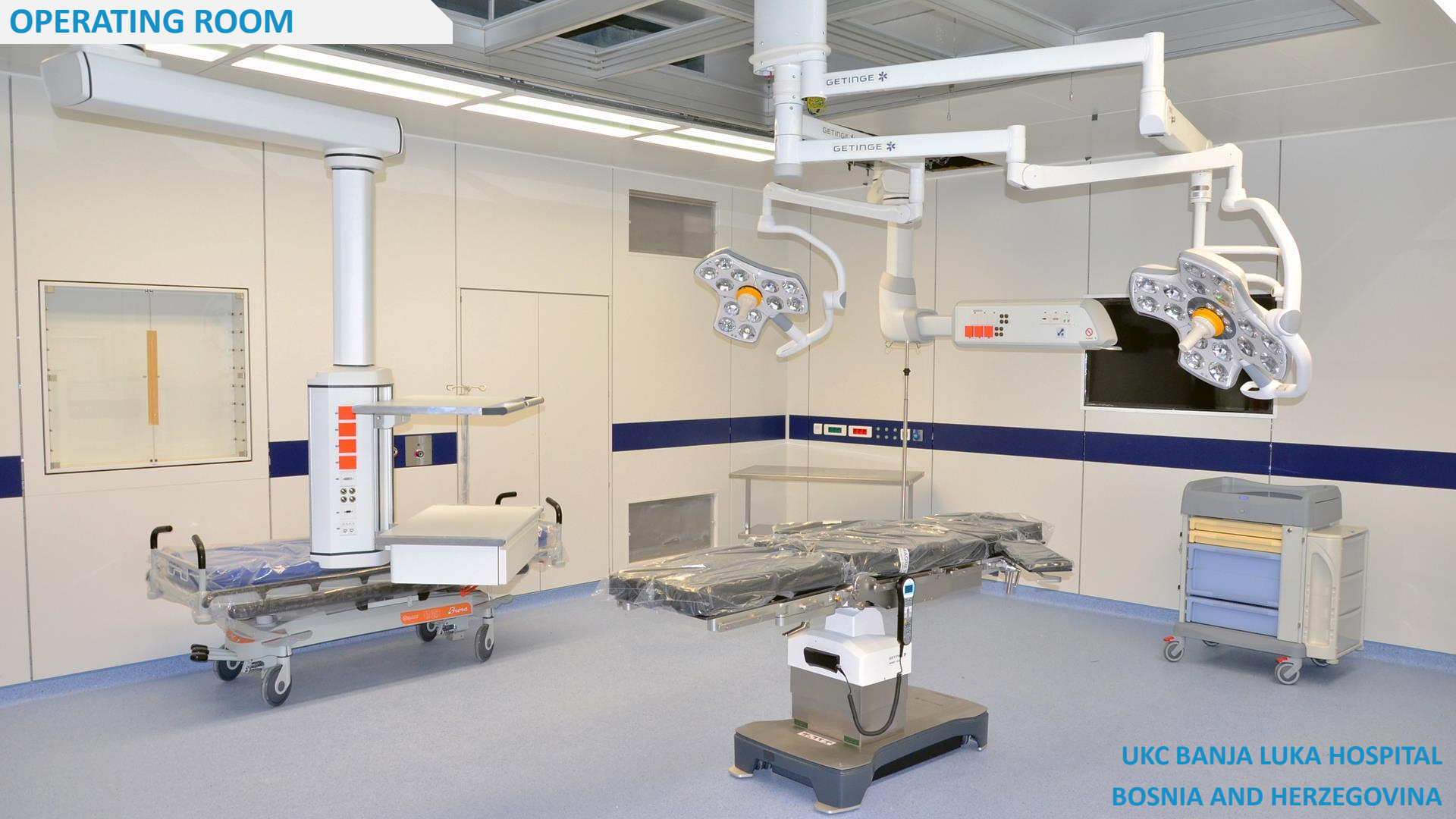

UKC BANJA LUKA HOSPITAL
BOSNIA AND HERZEGOVINA

OPERATING ROOM



NOVI SAD NEW HOSPITAL
SERBIA

HYBRID OPERATING ROOM

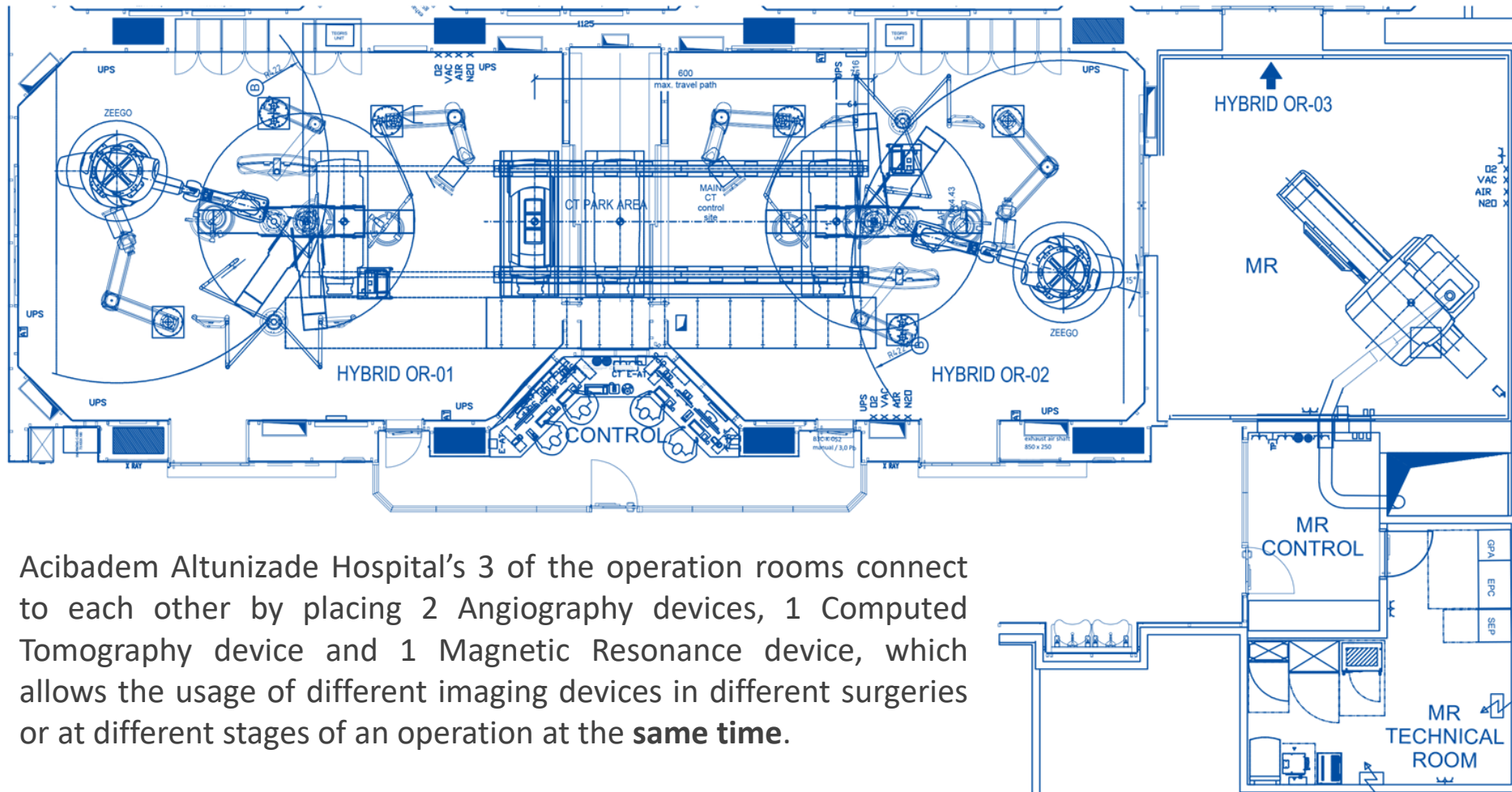

Acibadem Altunizade Hospital's 3 of the operation rooms connect to each other by placing 2 Angiography devices, 1 Computed Tomography device and 1 Magnetic Resonance device, which allows the usage of different imaging devices in different surgeries or at different stages of an operation at the **same time**.

HYBRID OPERATING ROOM

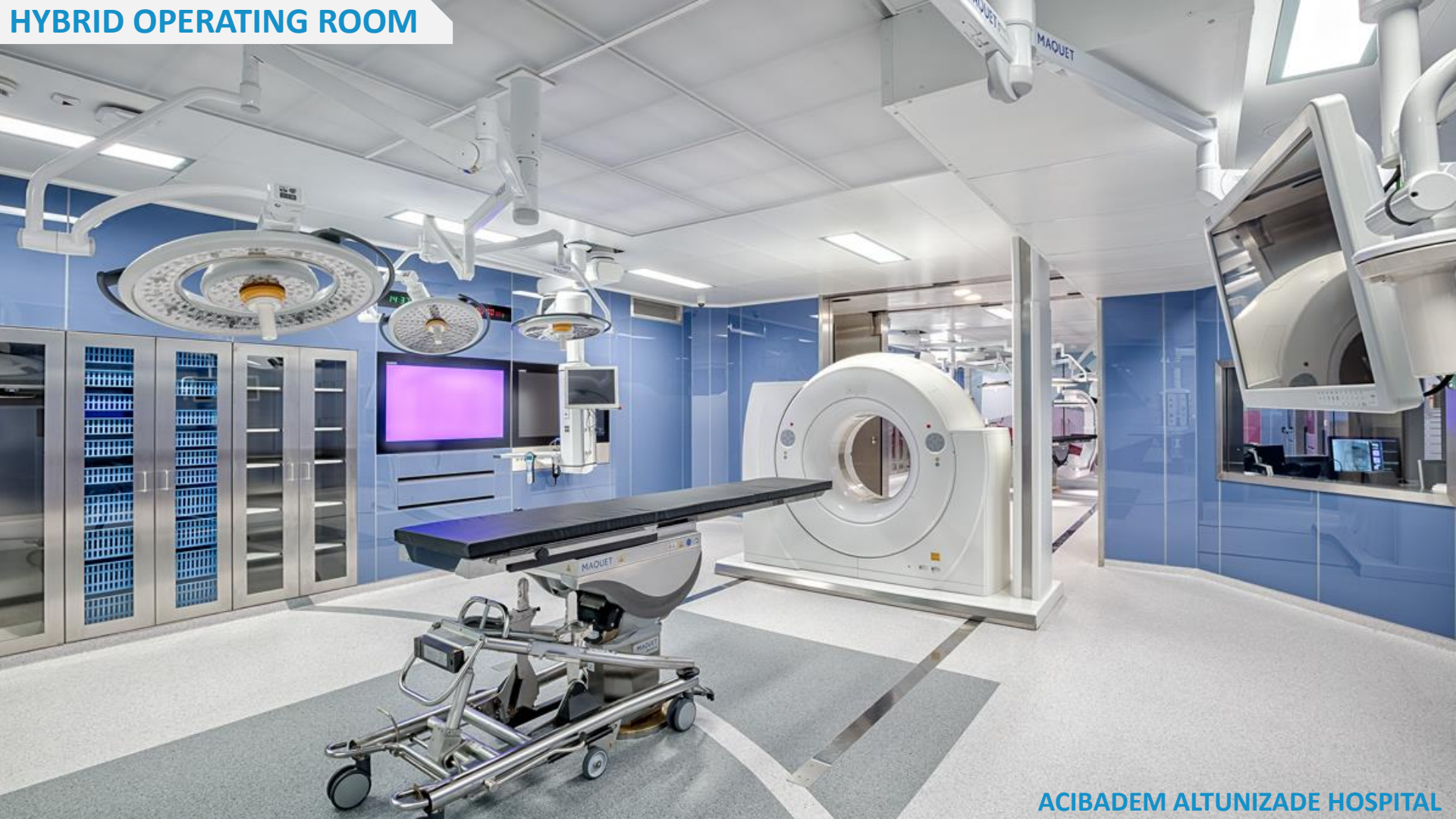

HYBRID OPERATING ROOM



ACIBADEM ALTUNIZADE HOSPITAL

CORRIDOR



ACIBADEM PROJECT
MANAGEMENT OFFICE
MOCK-UP O.R. SHOWROOM





INTENSIVE CARE UNIT



INTENSIVE CARE UNIT



INTENSIVE CARE UNIT



IVF PROCEDURE ROOM



DELIVERY ROOM



STERILIZATION







THANK YOU FOR YOUR ATTENTION